

## 1. Charging

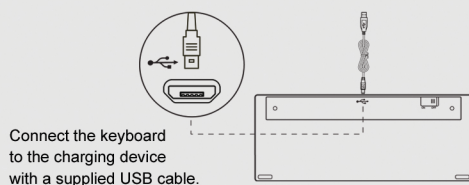

## 2. Connecting the receiver to the computer

Connect the receiver to a USB port in the computer – the device will automatically install the drivers. Set the power on/off switch on the reverse side of the keyboard to turn it on.



### Touchpad

Swipe

Single finger tap

Two-finger tap

Three-finger tap



### Mouse

Cursor move

Left click

Right click

Middle click

2

## 5. Restoring the keyboard to default settings

To restore the keyboard to default settings press and hold ESC+K keys and connect the receiver to a USB port.

## Proper disposal of the product



This symbol appearing on the product, on the product accessories or documentation means that when the product durability is over, neither the product nor its accessories (such as USB cable) should be disposed as household waste. By proper disposal of and recycling the product you can prevent possible negative impact on the environment and human health.

## MANUFACTURER'S DECLARATION

ARKAS Sp. z o. o. hereby declares that this product is compliant with the fundamental requirements and other relevant provisions of Directive 2004/108/EC and 1999/5/EC; therefore, the product has been CE marked and an EC declaration of conformity available on ARKAS Sp. z o. o.'s website at: [www.arkas.pl](http://www.arkas.pl) has been drawn up for the product.



4

## 3. Keyboard shortcuts

The keyboard features 11 media functions as well as 16 (T401) and 17 (T402) keyboard shortcuts, and their functions may change depending on the operating system or application being used.

F1 ([RF]) Re-pair with the dongle (device)

F2 (magnifying glass) Start searching for files (windows), go to search window in the internet browser (windows)

F3 (note) Start the default multimedia player (windows)

F4 ([<]) Go to the previous track – in media player

F5 ([>]) Go to the next track – in media player

F6 (speaker) Volume up – system sound

F7 (speaker) Volume down – system sound

F8 ([>|]) Pause / play

F9 ([+]) Stop – in media player

F10 (speaker) Disable the system sounds

F11 (letter) Launching the default mail application

F12 (home) Starting system browser

(insert) - Padlock Lock/Unlock the alphanumeric keypad

## 4. Touchpad

The keyboard has a built-in Touchpad.

## 5. Indicator lights



The indicator light is pulsing quickly – pairing in progress

The indicator light is pulsing – the device is working  
RF – Pairing in progress (press and hold the key for more than 3 minutes to unpair the device)



The indicator light is pulsing – flat battery, or if in charging mode – the battery is fully charged

Caps

Caps – Caps Lock is turned on

3

# Xenic®

## USER GUIDE

## WIRELESS KEYBOARD 2.4G WITH TOUCHPAD



T 401, T 402

## SPECIFICATION

QWERTY layout media keyboard

- 11 media functions

- 80 low-profile, soft X-Scissors keys for a quieter typing response

- touchpad that can be used like a mouse

- in-built 280 mAh Li-ion battery

- battery life: up to 25 hours

- solid brushed steel case

- up to 10 metres receiving distance

- build-in storage compartment for USB receiver

- intelligent energy saving system

- compatible with Android, Linux, MS Windows

- dedicated to Smart TV, consoles (PS3, XBOX), tablets

## SYSTEM REQUIREMENTS

Compatible with Android, Linux, MS Windows